

PRODUCT SPECIFICATION

Hydroguard Series e420 - Thermostatic Mixing Valves e427 (Concealed)/e428 (Exposed)

DESCRIPTION

The Series e427 and e428 Hydroguard valves automatically mix hot and cold water to deliver blended water at any desired temperature within a specified range. The assembly contains an advanced thermal actuator which maintains the selected water temperature within rigid tolerances despite temperature and pressure fluctuations in the water supply.

Construction features include a built-in shutoff valve for delivery water, a poppet type mixing valve, a concealed adjustment for raising and lowering the temperature range, and corrosion resistant parts.

The Series e427/e428 Hydroguard is simply constructed. All parts are accessible from the front, to facilitate cleaning and maintenance.

The Series e427/e428 Hydroguard is preferred for a wide variety of applications because of its accuracy, reliability, and economy of water and energy. It is chiefly used in showers, baths, hospital hydrotherapy and residential areas, where precise, consistent water temperature is required.

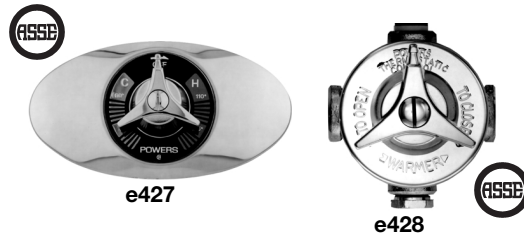

SPECIFICATIONS, DIMENSIONS AND FLOW RATE CURVES & CHECKSTOPS

Maximum Hot Water Supply Temperature190°F (88°C)
Minimum Hot Water Supply Temperature10°F (6°C) above set point
Maximum Operating Pressure125PSI (861 kPa)
Temperature Range (standard)90-110°F (32-43°C)
(low temperature)60-100°F (16-38°C)
(high temperature)100-160°F (38-71°C)
Connections1/2" NPT
Capacity14GPM* (.90 l/s)
Minimum Flow2.5 gpm
Maximum Static Pressure125 PSI (861 kPa)
Finish	Chrome Plated on e428, Rough Bronze on e427
ListingASSE 1016
ComplianceCSA B125 Certified
Shipping Weight6 lbs.

All Hydroguard Series e420 thermostatic mixing valves meet above performance specifications based on typical operating conditions as stated in ASSE 1016 (45 psi pressure differential, hot water supply between 140°-180°F [60-82°C], cold water supply less than 70°F [21°C]).

If your operating conditions vary from those stated in the standard, performance may vary as well. Consult your local sales representative or a Powers factory engineer to discuss your specific application.

* At 45 psi differential [310 kPa], with hot water supply between 140°-180°F [60-82°C].

e427

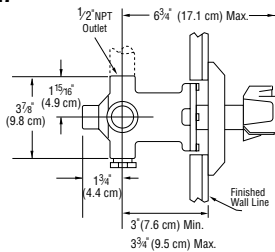

e428

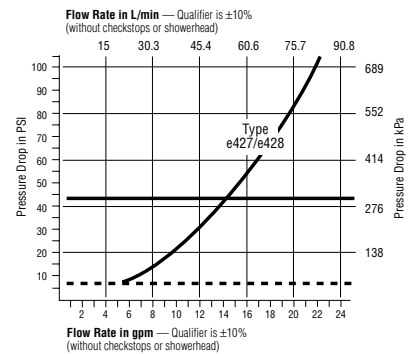
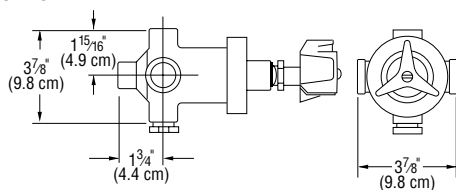

Type A, B, C

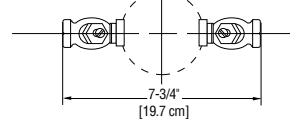

Type D

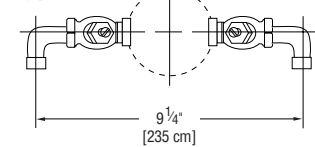

Type E, F

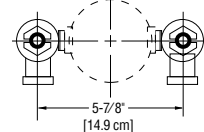

HOW TO SPECIFY: TYPE e427 & e428 VALVES FOR SHOWER AND TUB/SHOWER SYSTEMS

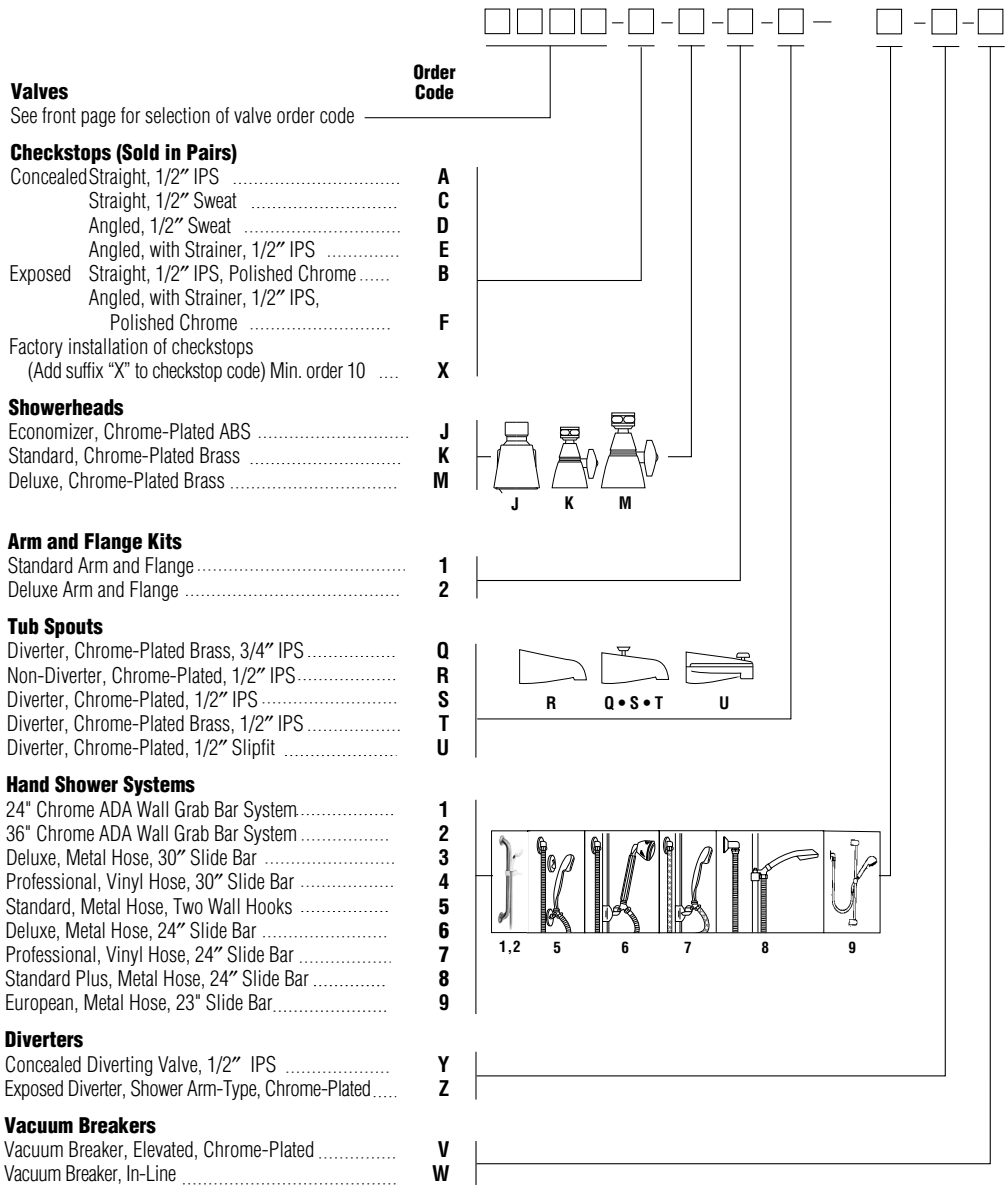

ENGINEERING APPROVAL

Project: _____

Contractor: _____

Architect/Engineer: _____

<p>POWERS</p> <p>A WATTS INDUSTRIES CO.</p>	<p>USA office: Phone: 800.669.5430 • Canadian office: Phone: 888.208.8927</p> <p>www.powerscontrols.com</p> <p>© 2003 Powers, a Watts Industries Co.</p>
--	--